

\\c:\p\projects\2024\2024-03-05\B-6034\Structures\Final Plans\Current Plans\_2024\MDL\_003\_B6034\_SMU\_GD\_S02.dgn  
DATE: 1/6/2026  
TIME: 11:16:26  
DWN BY: WDC  
CHKD BY: HLW  
DES, EGR, OF RECORD: ACO

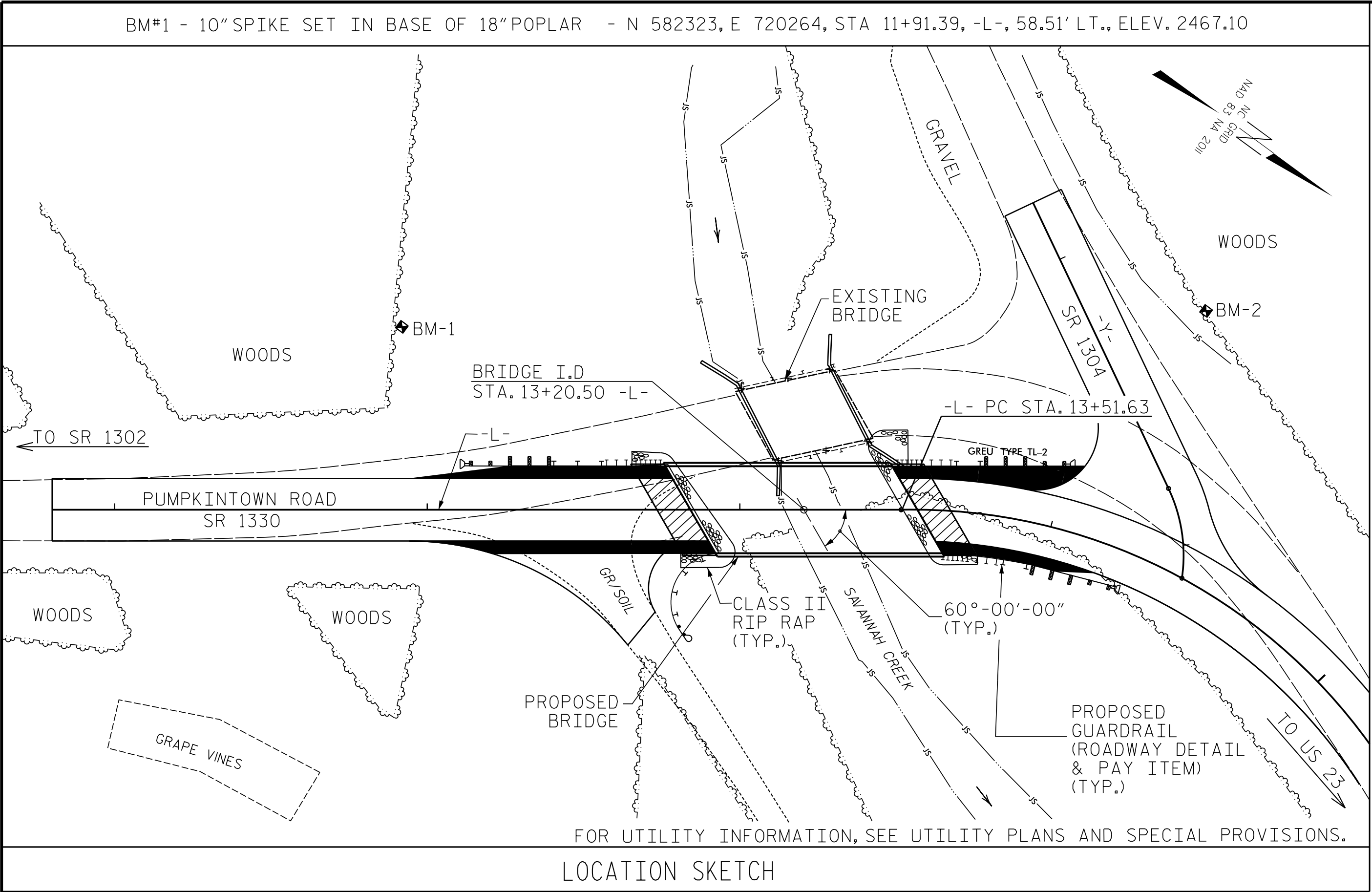

HYDRAULIC DATA			
DESIGN DISCHARGE	= 2000	CFS	
DESIGN FREQUENCY	= 25	YRS	
DESIGN HW ELEVATION	= 2445.6	FT	
BASE DISCHARGE	= 2800	CFS	
BASE FREQUENCY	= 100	YRS	
BASE HW ELEVATION	= 2446.9	FT	

OVERTOPPING FLOOD DATA			
OVERTOPPING DISCHARGE	= 3700(+)	CFS	
OVERTOPPING FREQUENCY	= 500 (+)	YRS	
OVERTOPPING ELEVATION	= 2450.4	FT	

DRAINAGE AREA	= 9.0	SQ MI	
---------------	-------	-------	--

GENERAL NOTES:

ASSUMED LIVE LOAD = HL-93 OR ALTERNATE LOADING.

THIS BRIDGE HAS BEEN DESIGNED IN ACCORDANCE WITH THE REQUIREMENTS OF THE AASHTO LRFD BRIDGE DESIGN SPECIFICATIONS.

THIS BRIDGE IS LOCATED IN SEISMIC ZONE 1.

FOR OTHER DESIGN DATA AND GENERAL NOTES, SEE SHEET SN.

FOR SUBMITTAL OF WORKING DRAWINGS, SEE SPECIAL PROVISIONS.

FOR FALSEWORK AND FORMWORK, SEE SPECIAL PROVISIONS.

FOR CRANE SAFETY, SEE SPECIAL PROVISIONS.

FOR GROUT FOR STRUCTURES, SEE SPECIAL PROVISIONS.

THE CONTRACTOR SHALL PROVIDE INDEPENDENT ASSURANCE SAMPLES OF REINFORCING STEEL AS FOLLOWS: FOR PROJECTS REQUIRING UP TO 400 TONS OF REINFORCING STEEL, ONE 30 INCH SAMPLE OF EACH SIZE BAR USED, AND FOR PROJECTS REQUIRING OVER 400 TONS OF REINFORCING STEEL, TWO 30 INCH SAMPLES OF EACH SIZE BAR USED. THE SAMPLE BARS SHOULD COME FROM STEEL ACTUALLY USED IN THE PROJECT AND THE SAMPLE BARS SHOULD BE REPLACED BY SPLICED BARS AS SPECIFIED IN THE SAMPLE BAR REPLACEMENT CHART. PAYMENT FOR THE SAMPLE BARS AND REPLACEMENT REINFORCING STEEL SHALL BE CONSIDERED INCIDENTAL TO VARIOUS PAY ITEMS.

WEARING SURFACE WILL BE PLACED BY THE DIVISION OF HIGHWAYS.

INASMUCH AS THE PAINT SYSTEM ON THE EXISTING STRUCTURAL STEEL CONTAINS LEAD, THE CONTRACTOR'S ATTENTION IS DIRECTED TO ARTICLE 107-1 OF THE STANDARD SPECIFICATIONS, ANY COSTS RESULTING FROM COMPLIANCE WITH APPLICABLE STATE OR FEDERAL REGULATIONS PERTAINING TO HANDLING OF MATERIALS CONTAINING LEAD BASED PAINT SHALL BE INCLUDED IN THE BID PRICE FOR REMOVAL OF EXISTING STRUCTURE AT STATION 13+20.50 -L-.

THE MATERIAL SHOWN IN THE CROSS-HATCHED AREA SHALL BE EXCAVATED FOR A DISTANCE OF 25 FT. EACH SIDE OF CENTERLINE ROADWAY AS DIRECTED BY THE ENGINEER. THIS WORK WILL BE PAID FOR AT THE CONTRACT LUMP SUM PRICE FOR UNCLASSIFIED STRUCTURE EXCAVATION. SEE SECTION 412 OF THE STANDARD SPECIFICATIONS.

FOR LIMITS OF TEMPORARY SHORING FOR MAINTENANCE OF TRAFFIC, SEE TRAFFIC CONTROL PLANS. FOR PAY ITEM FOR TEMPORARY SHORING FOR MAINTENANCE OF TRAFFIC, SEE ROADWAY PLANS.

AFTER SERVING AS A TEMPORARY STRUCTURE, THE EXISTING STRUCTURE CONSISTING OF 1 SPAN AT 31 FT. LONG WITH TIMBER FLOOR AND I-BEAMS, 24 FT. CLEAR ROADWAY, ON CONCRETE ABUTMENTS, AND LOCATED AT THE EXISTING STRUCTURE, SHALL BE REMOVED. THE EXISTING BRIDGE IS PRESENTLY POSTED FOR LOAD LIMIT. SHOULD THE STRUCTURAL INTEGRITY OF THE BRIDGE DETERIORATE DURING CONSTRUCTION OF THE PROPOSED BRIDGE, A LOAD LIMIT MAY BE POSTED AND MAY BE REDUCED AS FOUND NECESSARY DURING THE LIFE OF THE PROJECT.

THE SUBSTRUCTURE OF THE EXISTING BRIDGE INDICATED ON THE PLANS IS FROM THE BEST INFORMATION AVAILABLE. SINCE THIS INFORMATION IS SHOWN FOR THE CONVENIENCE OF THE CONTRACTOR, THE CONTRACTOR SHALL HAVE NO CLAIM WHATSOEVER AGAINST THE DEPARTMENT OF TRANSPORTATION FOR ANY DELAYS OR ADDITIONAL COST INCURRED BASED ON DIFFERENCES BETWEEN THE EXISTING BRIDGE SUBSTRUCTURE SHOWN ON THE PLANS AND THE ACTUAL CONDITIONS AT THE PROJECT SITE.

REMOVAL OF THE EXISTING BRIDGE SHALL BE PERFORMED SO AS NOT TO ALLOW DEBRIS TO FALL INTO THE WATER. THE CONTRACTOR SHALL REMOVE THE BRIDGE AND SUBMIT PLANS FOR DEMOLITION IN ACCORDANCE WITH ARTICLE 402-2 OF THE STANDARD SPECIFICATIONS.

THIS STRUCTURE HAS BEEN DESIGNED IN ACCORDANCE WITH "HEC 18- EVALUATING SCOUR AT BRIDGES".

FOR ASBESTOS ASSESSMENT, SEE SPECIAL PROVISIONS.

FOR CORED SLAB AND BOX BEAM POST TENSIONING, SEE SPECIAL PROVISIONS.

FOUNDATION NOTES:

FOR PILES, SEE SECTION 450 OF THE STANDARD SPECIFICATIONS.

CONCRETE IS REQUIRED TO FILL HOLES FOR PILE EXCAVATION AT END BENT NO. 1.

SAMPLE BAR REPLACEMENT					
SIZE	LENGTH	SIZE	LENGTH	SIZE	LENGTH
#3	6'-2"	#6	9'-8"	#9	13'-2"
#4	7'-4"	#7	10'-10"	#10	14'-6"
#5	8'-6"	#8	12'-0"	#11	15'-10"

NOTE: SAMPLE BAR REPLACEMENT LENGTHS BASED ON 30" (SAMPLE LENGTH) PLUS TWO SPLICE LENGTHS AND  $f_y = 60\text{ksi}$

TOTAL BILL OF MATERIAL																			
	REMOVAL OF EXISTING STRUCTURE	ASBESTOS ASSESSMENT	PILE EXCAVATION IN SOIL	PILE EXCAVATION NOT IN SOIL	UNCLASSIFIED STRUCTURE EXCAVATION	CLASS A CONCRETE	BRIDGE APPROACH SLABS	REINFORCING STEEL	PILE DRIVING EQUIPMENT SETUP FOR HP 12 X 53 STEEL PILES	HP 12 X 53 STEEL PILES		STEEL PILE POINTS	DYNAMIC PILE TESTING	VERTICAL CONCRETE BARRIER RAIL	RIP RAP CLASS II (2'-0" THICK)	GEOTEXTILE FOR DRAINAGE	ELASTOMERIC BEARINGS	3'-0" x 2'-0" PRESTRESSED CONCRETE CORED SLABS	
	LUMP SUM	LUMP SUM	LIN. FT.	LIN. FT.	LUMP SUM	CU. YARDS	LUMP SUM	LBS.	EACH	NO.	LIN. FT.	EACH	EACH	LIN. FT.	TONS	SQ. YARDS	LUMP SUM	NO.	LIN. FT.
SUPERSTRUCTURE							LUMP SUM							140.29			LUMP SUM	10	700.00
END BENT 1			30.0	10.0		22.6		2801	5	5	145	5			70	78			
END BENT 2						22.6		2801	5	5	130	5			110	122			
TOTAL	LUMP SUM	LUMP SUM	30.0	10.0	LUMP SUM	45.2	LUMP SUM	5602	10	10	275	10	1	140.29	180	200	LUMP SUM	10	700.00

PROJECT NO. B-6034  
JACKSON COUNTY  
STATION: 13+20.50 -L-

SHEET 3 OF 3



**DOCUMENT NOT CONSIDERED FINAL  
UNLESS ALL SIGNATURES COMPLETED**

**JMT** Johnson, Mirmiran, & Thompson Inc.  
4700 Falls of Neuse Rd, Suite 100,  
Raleigh, NC 27609  
License No: C-3097

DEPARTMENT OF TRANSPORTATION RALEIGH					
GENERAL DRAWING FOR BRIDGE OVER SAVANNAH CREEK ON SR 1330 (PUMPKINTOWN RD.) BETWEEN CHESTNUT COVE RD. (1302 AND US 23					
REVISIONS					
NO.	BY:	DATE:	NO.	BY:	DATE:
1			3		
2			4		
SHEET NO. S-2					TOTAL SHEETS 20